

# Slim 40G

## Applications

- | Recreational Vehicles
- | Transportation Connectivity
- | Home / Office



## Ultra Wide Bandwidth

Wide frequency range  
(600-6000MHz) supporting  
LTE and 5G connectivity.

## Built for 5G

Omni-directional 4x4 MIMO  
mobile antenna for the best  
performance.





## Low Profile Design

High performance in a small size and durable housing.

## Easy Installation

Can be mounted on a wall window or wall or hidden under a vehicle dashboard.



## Specification

Cellular		Cable (Cellular)	
Antenna Elements	4 elements	Type	CFD-200 (Cellular)
Peak Gain & Frequencies	3.6dBi: 617-960MHz 6.1dBi: 1710-2700MHz 6.7dBi: 3400-4200MHz 8.1dBi: 5000-6000MHz	Loss	0.33 dB/m @ 900 MHz 0.49 dB/m @ 2000 MHz 0.55 dB/m @ 2500 MHz 0.87 dB/m @ 5800 MHz
VSWR	<2.5 over 90% of the band	Diameter	0.2" / 5.0mm
Feed Power Handling	10W	Jacket	Half matt PVC, UV resistant
Input Impedance	50 Ω	Termination	SMA male
Polarisation	Linear		
GPS		Cable (GPS)	
Frequency Range	1561-1602 MHz	Type	RG-174 (GPS)
Peak Gain	0.5dBi @ 1575MHz 1.6dBi @ 1602MHz	Loss	3.4 dB/m @ 1000 MHz 4.9 dB/m @ 1800 MHz
VSWR	< 2	Diameter	0.1" / 2.7mm
Output Return Loss	10dB max	Jacket	Half matt PVC, UV resistant
Gain: LNA	28 ±3dB	Termination	SMA male
Noise Figure	1.5dB max at 3.3V		
Operating Voltage	3.3V		
Power Consumption	8.5 ±2.5mA at 3.3V		
Mechanical			
		Product Dimensions	7.09"x5.12"x0.59" / 180x130x15mm
		Packaged Dimensions	9.61"x3.15"x9.84" / 244x80x250mm
		Enclosure Material	UV stable PC
		Color	Black
Mounting			
Supported Types	Window, wall		
Package contents			
Antenna	Slim 40G	Accessories	Velcro strip (hook and loop fastener) (4pcs, length 4.7' / 120mm)

## Specification

Environmental, compliance			
IP Rating	IP55	Compliance	ROHS, REACH, WEEE
Operating Temperature	-40° - 176°F / -40° - 80°C	Enclosure Flammability	UL 94 HB
Storage Temperature	-40° - 176°F / -40° - 80°C	Cable Flammability	UL 758 (VW-1)
		UV Resistance	UL 746C (F1 long-term UV exposure)

## Ordering Information

Product Code	Description
ANT-SLM-40G-S-B-6	4xLTE/5G, 1xGPS 600-6000MHz, SMA, Black, 6.5 ft / 2m

## Technical Drawing

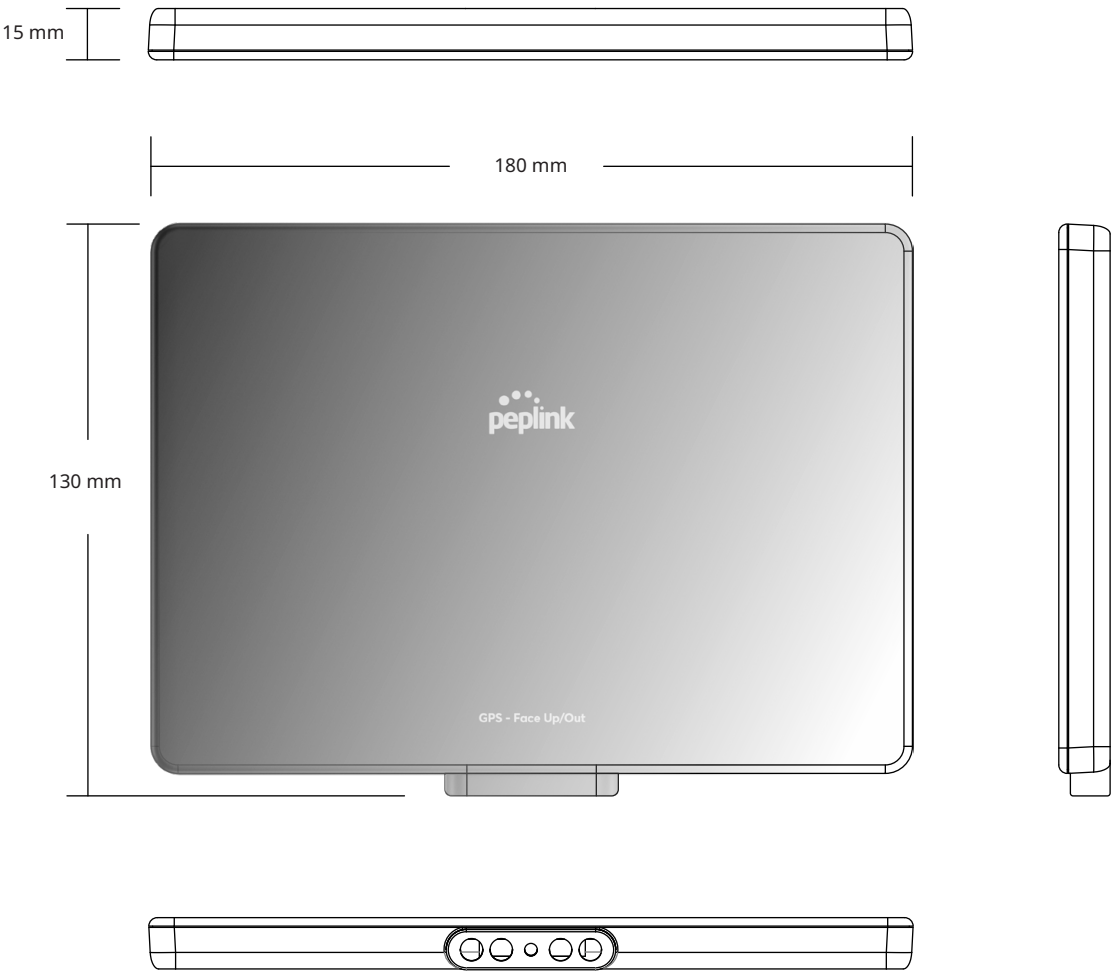



## Installation Recommendation

Step 1

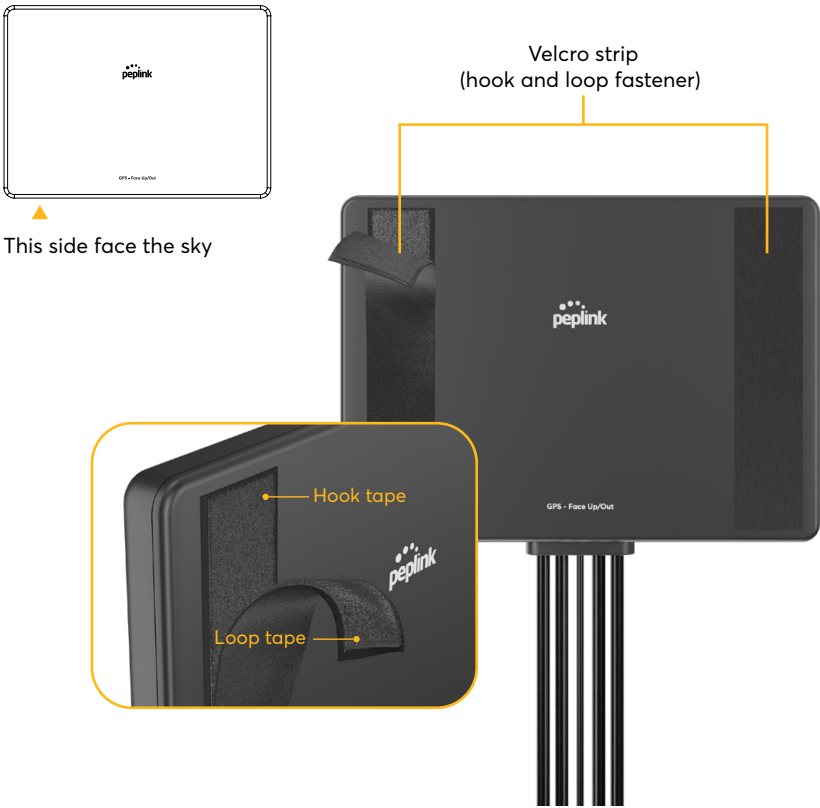

Step 2

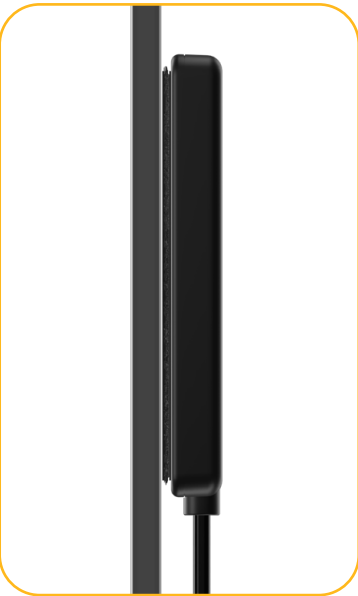

## Cellular Antenna Performance

### Cellular Antenna VSWR

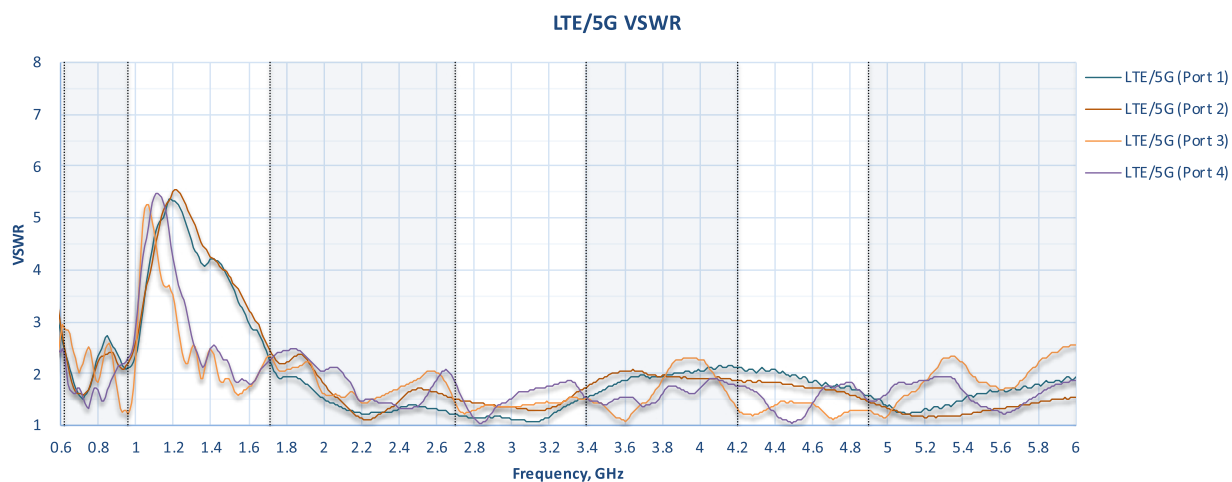

### Cellular Antenna Gain

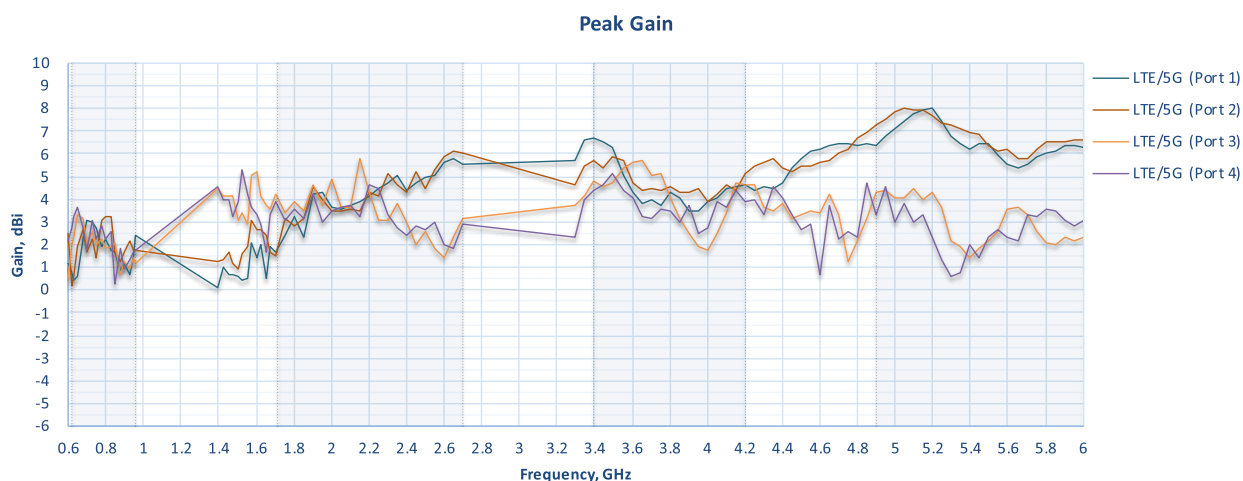

### Cellular Antenna Efficiency

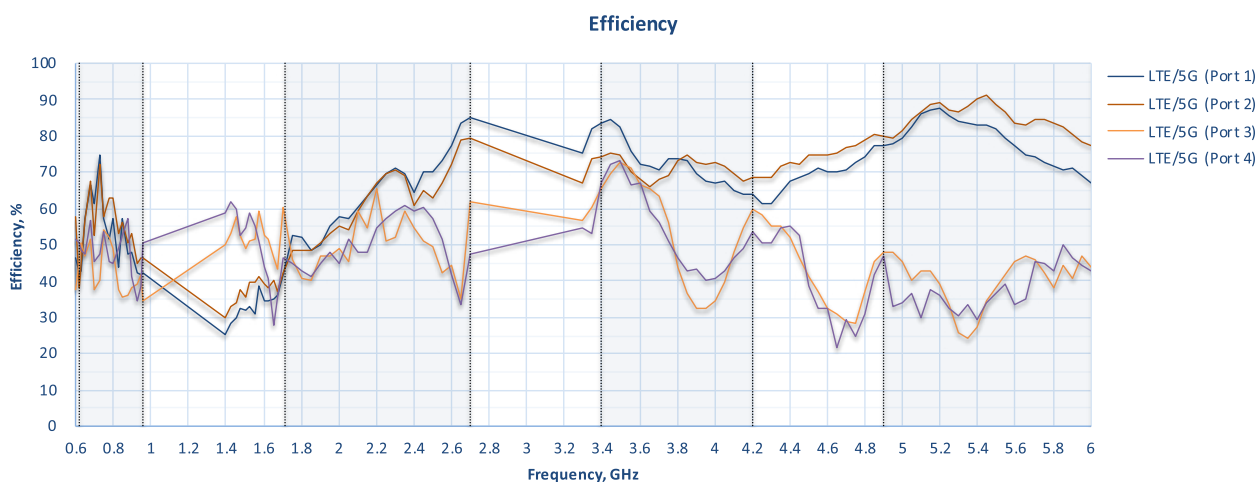

## Cellular Antenna Performance

Cellular Antenna Isolation

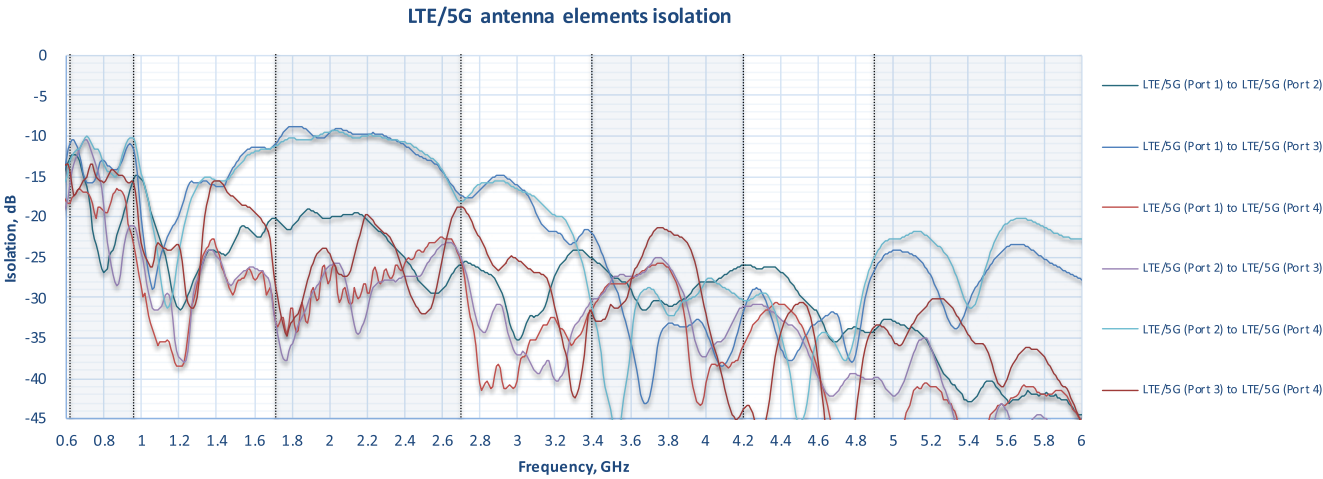

## Radiation Pattern

LTE Radiation Patterns (Azimuth)

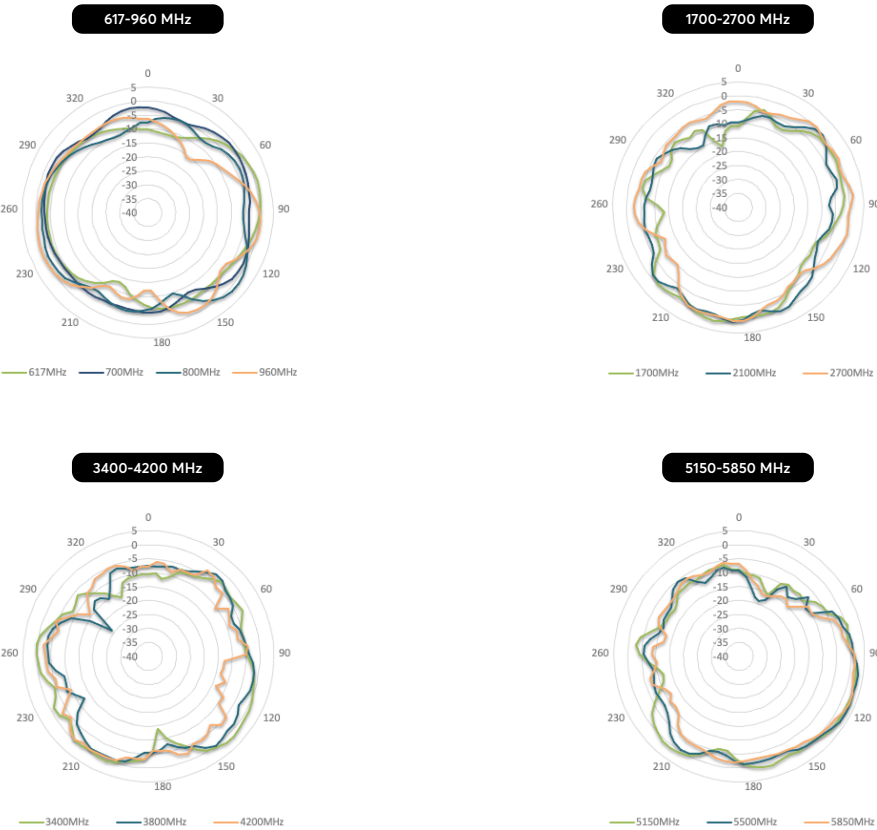



## Radiation Pattern

### LTE Radiation Patterns (Elevation 1)

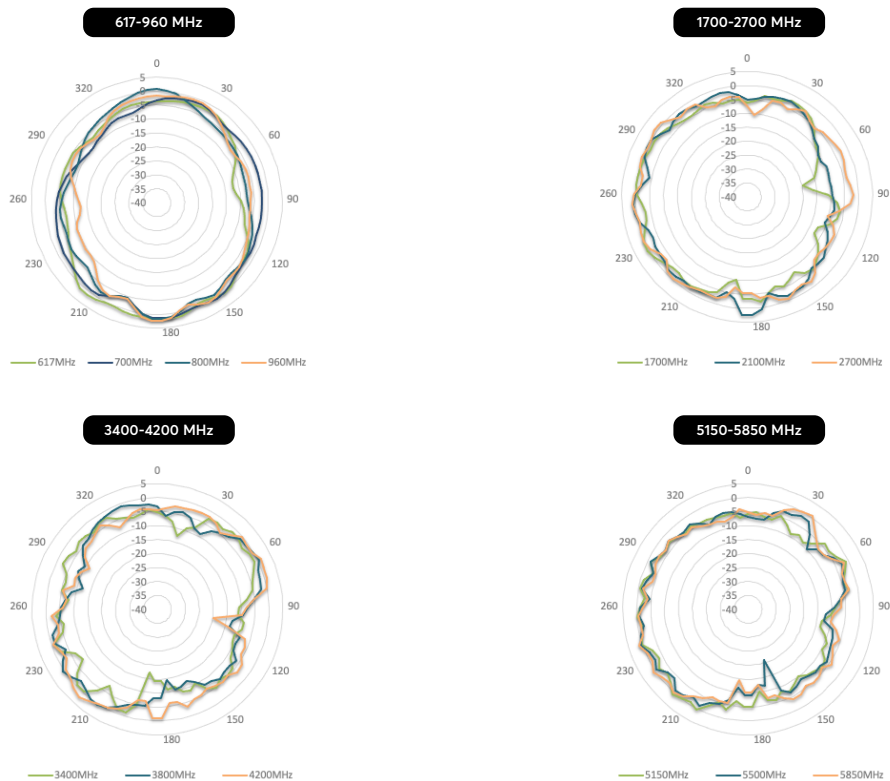

### LTE Radiation Patterns (Elevation 2)

